

REVISIONS		
REV. NO.	DESCRIPTION	DATE

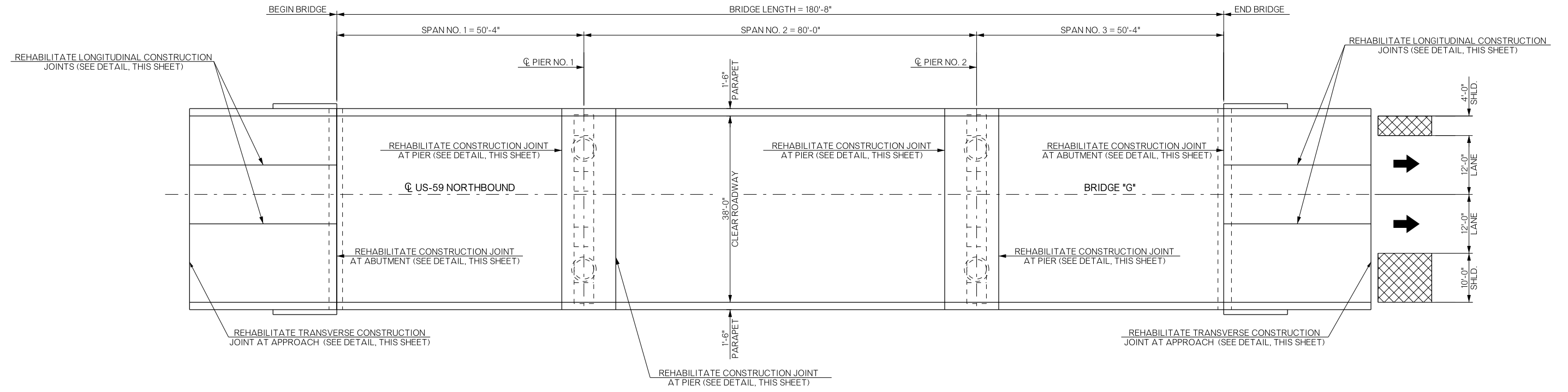

PLAN

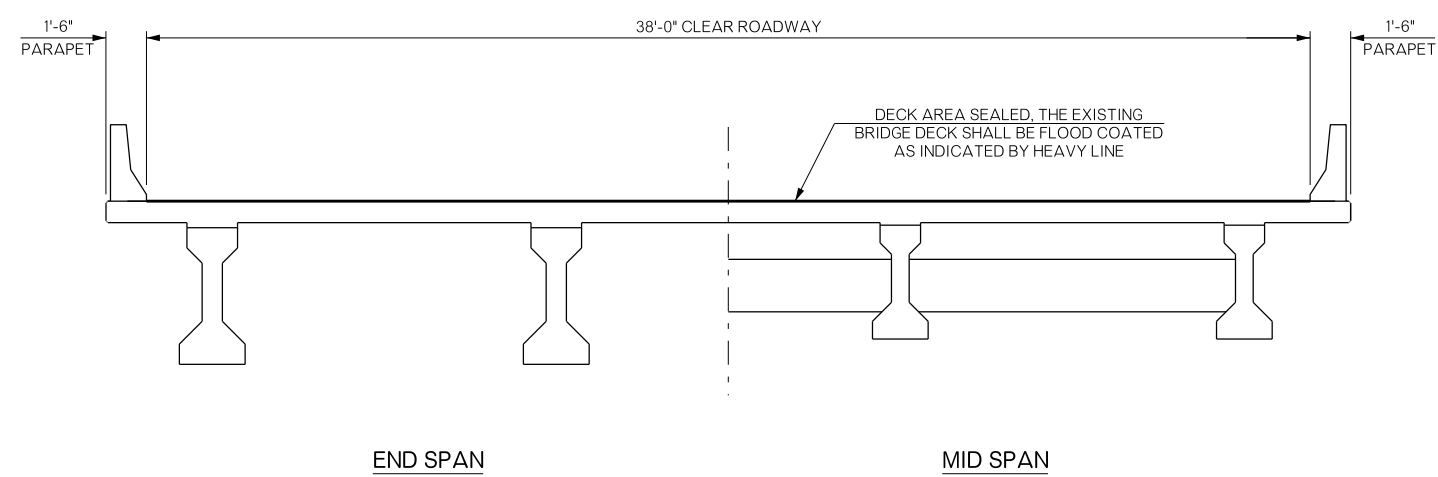

TYPICAL SECTION

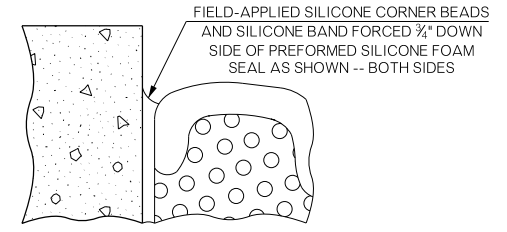

DETAIL 'A'

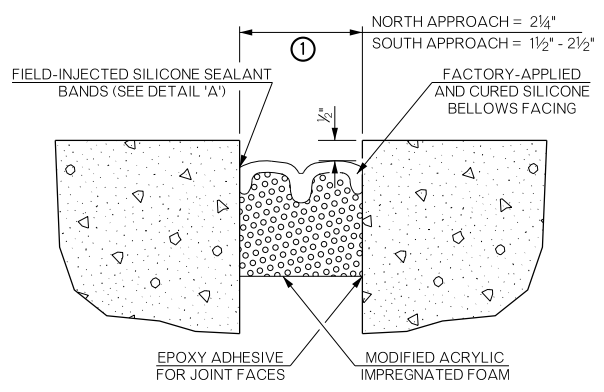

REHABILITATED TRANSVERSE CONSTRUCTION JOINT AT APPROACHES

① NORTH END APPROACH TO BE FOAM SEALED WITH A WIDTH AS SHOWN. SOUTH END APPROACH TO BE FOAM SEALED HAS A VARIABLE OPENING WIDTH AS SHOWN. (THESE VARIANCES SHOULD BE RESPECTED AND TAKEN INTO ACCOUNT IN THE FIELD. PREFORMED FOAM MAY NEED TO BE "STEPPE" (I.E. SECTIONED FROM DIFFERENT DEFAULT OFFERED WIDTHS.)

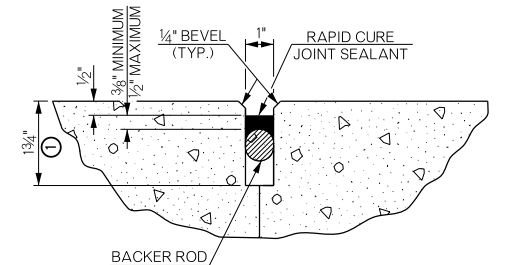

REHABILITATED CONSTRUCTION JOINT AT ABUTMENTS, PIERS, AND LONGITUDINAL CONSTRUCTION JOINT AT APPROACHES

① SAW TO THE DEPTH SHOWN TO PROVIDE CLEAN STRAIGHT SURFACES. REFER TO LECS-4-1 STANDARD DETAIL SHEET FOR ADDITIONAL INFORMATION.

BRIDGE "G" US-59 NORTH BOUND OVER COAL CREEK	LE FLORE COUNTY		Design	N/A	N/A
	GENERAL PLAN AND TYPICAL SECTION (BRIDGE "G")		Detail	MSW	5/17
STATE OF OKLAHOMA			DEPARTMENT OF TRANSPORTATION	Check	RAH
JOB PIECE NO. 33217(04)			Squad: HENSLEY		6/17
JOB PIECE NO. 33217(04)			Engr: DEFRANCO		
JOB PIECE NO. 33217(04)			SHEET NO. B010		